

Bra Kit Underwires from Fabric Depot

To determine the size of the underwire you need, use a length of solid copper wire to establish where the breast meets the rib cage, as shown in the photo. Then compare the shape of the copper wire to the chart below.

This chart shows the inside edge of the underwire. The dimensions shown are based on the size of the underwire required for a B Cup bra. When you specify the size you want, order by the color of the tip.

The first time you order, it is always best to order a size larger and a size smaller as well as the size you think you will need.



Color Tip
Ends

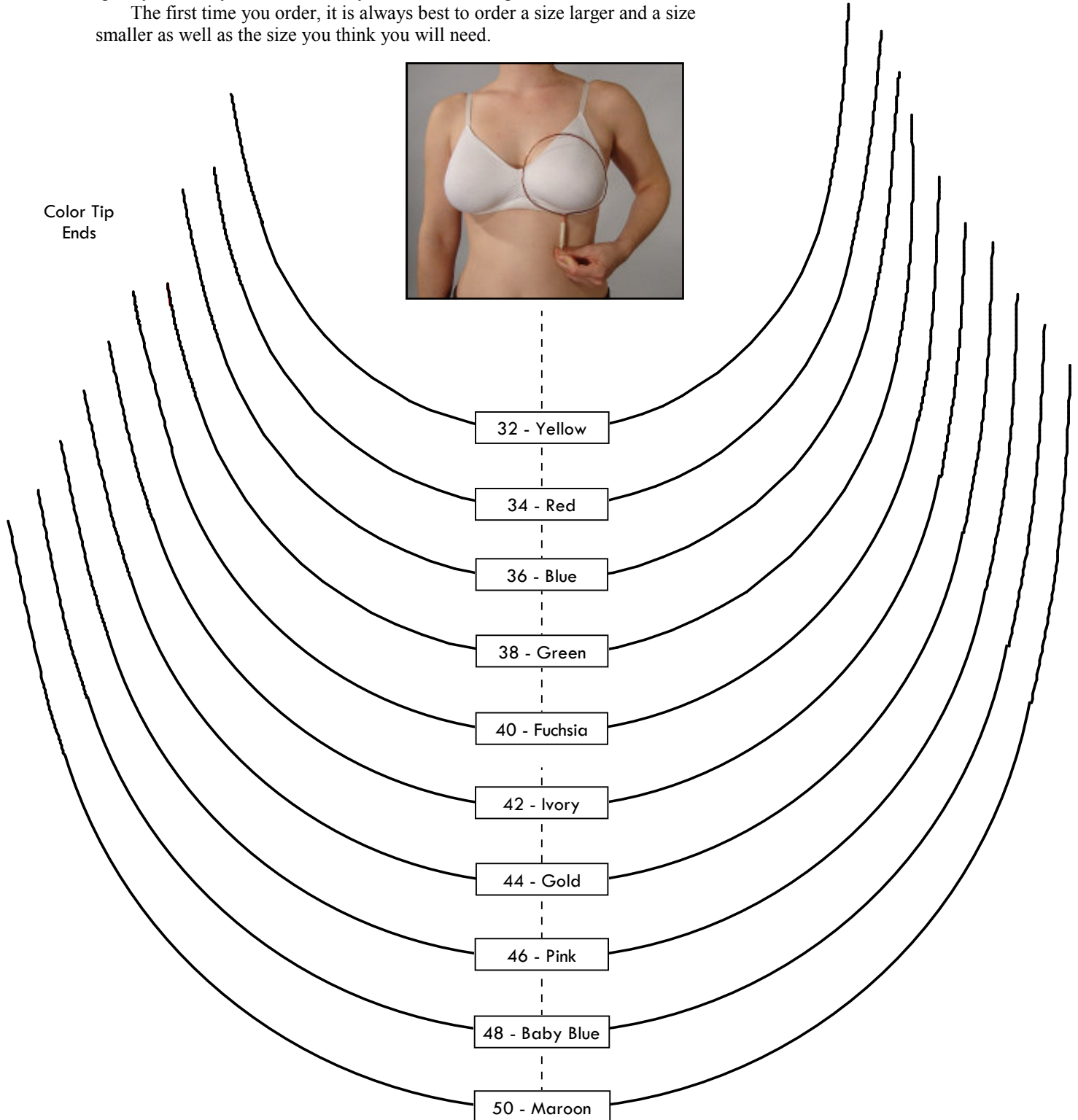

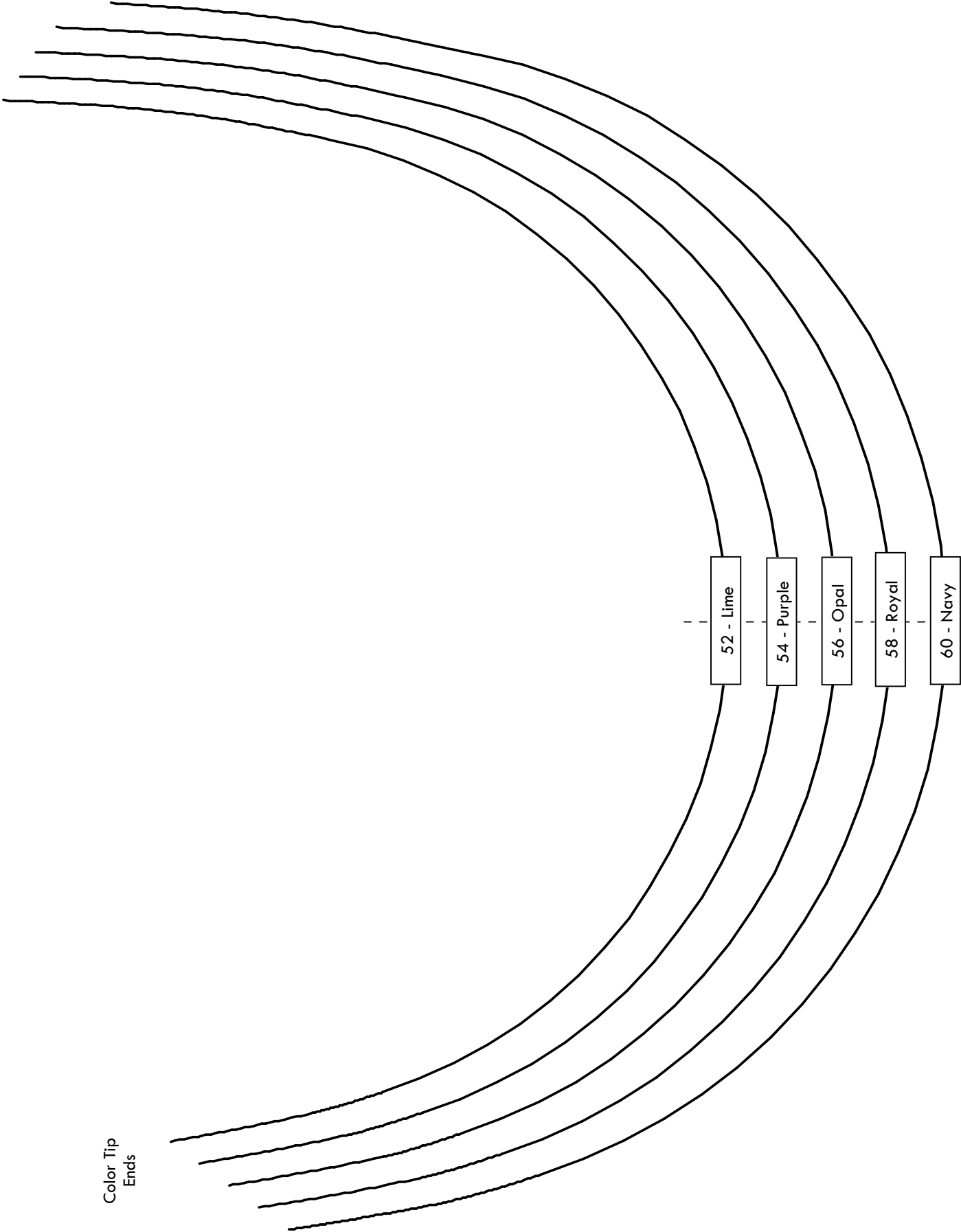

Color Tip
Ends

Printing PDF Files

The Adobe Acrobat print function can be set to shrink or expand pages. This will cause the patterns to be printed incorrectly. The phrasing of this function depends on the version of Acrobat that you are using. Two versions are shown below.

To verify the patterns are the correct size, measure the blue 8" x 10" (20.3cm x 25.4cm) boxes that appear around the edges of the pattern pages.

Another problem you may encounter is that the text in the sewing instructions prints additional characters. These characters do not appear when the pages are displayed. When this happens, select the "Print as image" function.

Acrobat Reader 5.0
In the "Copies and Adjustments" section, uncheck the boxes that say "Shrink oversized pages" and "Expand small pages."

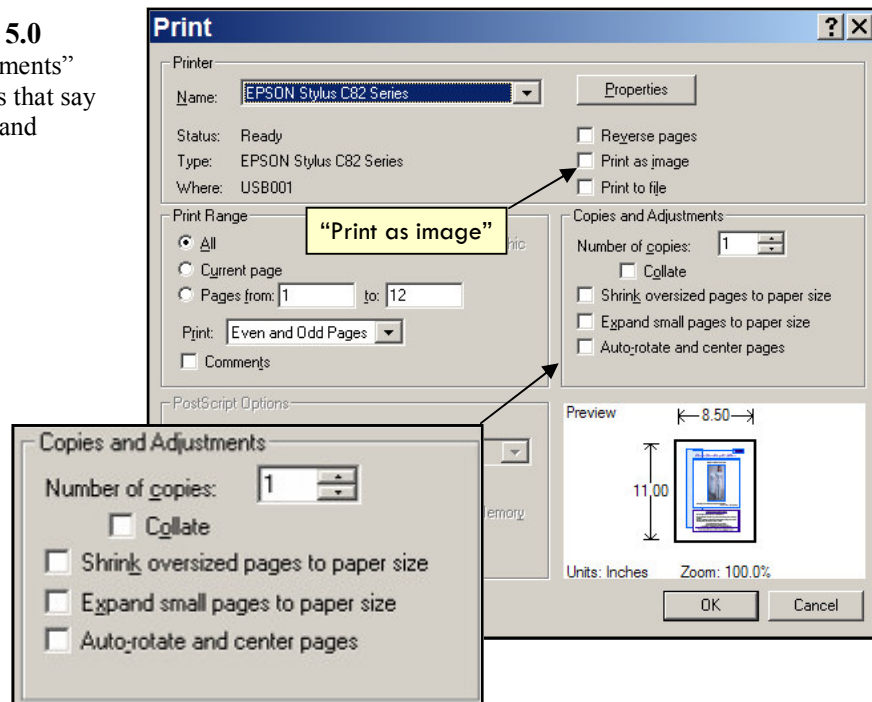

Acrobat Reader 6.0 & 7.0
In the "Page Handling" section, set "Page Scaling" to "None."

To access the "Print as image" checkbox, click the "Advanced" button.

